

CR SOCKET ABNT NBR 13715-6



Material	:	Cast steel
Steel Grade	:	R3S and R4
Finish	:	Painted or Galvanised
Temperature Range	:	-40 °C up to +200 °C
Standard Certification	:	Certificate of Conformity 3.1 Material Certificate EN 10204 Proof Load Certificate Can be Supplied with ABS and/or DNV Certificate for Offshore Mooring ^{1,2}

CR sockets give the best possible connection between a chain and a rope anchoring system.



These sockets include our non-rotating system (NRS-system) which prevents the tamp from turning or slipping out of the cone and guarantees a high performance connection.

Non-standard sizes or custom products available on request.

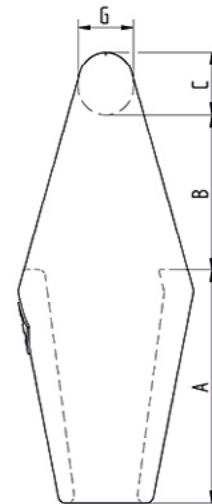
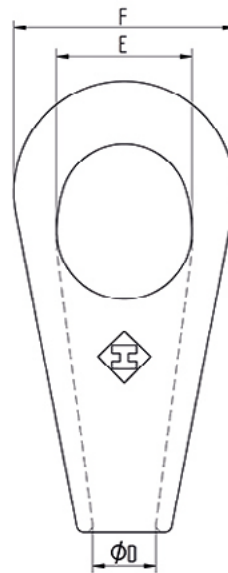

NR.	Rope Ø		Article number		PL	MBL	A	B	C	ØD	E	F	G	Weight
	mm	inch	painting RAL 5013 blue	galvanised	kN	kN	mm							kg ±
522	49 - 54	2 - 2 1/8	CR522P	CR522G	1480	2230	215	125	55	57	115	200	50	25
524	55 - 60	2 1/4 - 2 3/8	CR524P	CR524G	1834	2764	230	145	65	63	135	230	57	35
526	61 - 68	2 1/2 - 2 5/8	CR526P	CR526G	2426	3656	250	160	75	73	160	262	65	51
527	69 - 75	2 3/4 - 2 7/8	CR527P	CR527G	2785	4196	280	175	80	79	171	278	70	62
528	76 - 80	3 - 3 1/8	CR528P	CR528G	3242	4884	315	210	85	86	184	300	75	75
529	81 - 86	3 1/4 - 3 3/8	CR529P	CR529G	4323	6514	340	205	100	92	204	320	90	93
530	87 - 93	3 1/2 - 3 5/8	CR530P	CR530G	4323	6514	360	220	105	99	215	340	95	110
531	94 - 102	3 3/4 - 4	CR531P	CR531G	4862	7326	380	240	110	108	234	376	100	141
533	108 - 115	4 1/4 - 4 1/2	CR533P	CR533G	7065	9773	450	260	125	120	252	400	110	186

¹ When DNV-GL Product Certificate for Mooring is required, the test program as given in DNV-OS-E304 shall be followed.

² When ABS Product Certificate for Mooring is required, the test program as given in ABS Offshore Mooring Guide shall be followed.