

CR SOCKET STANDARD



Material	:	Cast steel - Grade R3S
Working Load Limit	:	20% of the MBL
Finish	:	Painted or Galvanised
Temperature Range	:	-40 °C up to +200 °C
Standard Certification	:	Certificate of Conformity 3.1 Material Certificate EN 10204 Proof Load Certificate ¹ ABS Type Approval ²

TYPE APPROVED PRODUCT

 DNV-GL



SOCKETS

CR sockets give the best possible connection between a chain and a rope anchoring system.



These sockets include our non-rotating system (NRS-system) which prevents the tamp from turning or slipping out of the cone and guarantees a high performance connection.

Non-standard sizes or custom products available on request.

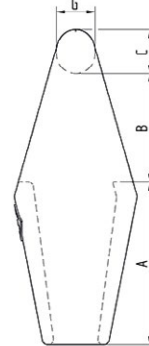
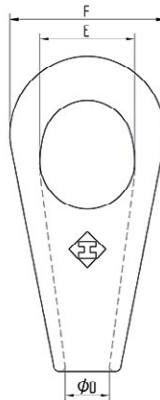

NR.	Rope Ø	Article number		MBL	A	B	C	ØD	E	F	G	Weight
	mm	paintied RAL 5013 blue	galvanised									
512	31 - 36	CR512P	CR512G	140	140	85	38	39	75	124	35	7
517	37 - 42	CR517P	CR517G	160	160	110	42	44	92	150	38	11
519	43 - 48	CR519P	CR519G	200	188	128	50	51	110	180	45	18
522	49 - 54	CR522P	CR522G	250	215	125	55	57	115	200	50	25
524	55 - 60	CR524P	CR524G	300	230	145	65	63	135	230	57	35
526	61 - 68	CR526P	CR526G	400	250	160	75	73	160	262	65	51
527	69 - 75	CR527P	CR527G	500	280	175	80	79	171	278	70	62
528	76 - 80	CR528P	CR528G	600	315	210	85	86	184	300	75	75
529	81 - 86	CR529P	CR529G	700	340	205	100	92	204	320	90	93
530	87 - 93	CR530P	CR530G	800	360	220	105	99	215	340	95	110
531	94 - 102	CR531P	CR531G	900	380	240	110	108	234	376	100	141
533	108 - 115	CR533P	CR533G	1000	450	260	125	120	252	400	110	186
540	122 - 130	CR540P	CR540G	1250	517	293	140	140	275	460	125	317

¹ Sockets are proof loaded at 40% of the MBL up to an MBL of 875 Mtons.

² When ABS Product Certificate for Mooring is required, the test program as given in ABS Offshore Mooring Guide shall be followed.