

OPEN WEDGE SOCKET WITH PIN

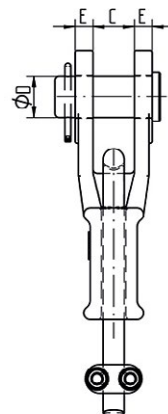

Material	:	Cast steel
Working Load Limit	:	20% of the MBL
Finish	:	Painted or Galvanised (< Type No. 6 standard galvanised)
Temperature Range	:	-40 °C up to +200 °C
Standard Certification	:	Certificate of Conformity 3.1 material certificate EN 10204

Non-standard sizes or custom products available on request.

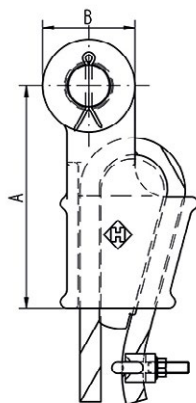

NR.	Rope Ø mm	Article number		MBL tons	A	B	C	ØD	E	Weight kg ±
		painting RAL 5013 blue	galvanised							
0.5	9-10	-	OWSP0,5G	10	146	47	20,5	20	11	1,7
1	11-13	-	OWSP1G	16	146	57	25,5	25	12	2,3
2	14-16	-	OWSP2G	25	176	70	32	30	14	3,9
3	17-19	-	OWSP3G	32	212	80	38	35	16	6,1
4	20-22	-	OWSP4G	45	240	96	44	41	19	9,3
5	23-26	-	OWSP5G	70	274	114	51	51	22	14,8
6	27-29	OWSP6P	OWSP6G	100	310	130	57	57	25	21,1
7	30-33	OWSP7P	OWSP7G	110	350	146	63	63	28	32,8
8	34-36	OWSP8P	OWSP8G	125	400	148	69	63	28	39,3
9	37-40	OWSP9P	OWSP9G	150	450	160	76	70	30	52,5
10	41-43	OWSP10P	OWSP10G	200	500	174	76	76	33	67,5
11	44-48	OWSP11P	OWSP11G	260	550	200	89	89	39	98,2
12	49-53	OWSP12P	OWSP12G	280	650	200	101	95	46	122,5
13	56	OWSP13P	OWSP13G	360	660	250	113	108	53	178,4
14	63	OWSP14P	OWSP14G	450	840	270	127	121	60	281
15	75	OWSP15P	OWSP15G	520	1000	300	146	133	76	469
16	81-86	OWSP16P	OWSP16G	625	1100	300	159	140	79	610