



LIGHT TYPE SNATCHBLOCK

Material	:	Mild steel
Safety Factor	:	4 times
Finish	:	Painted
Temperature Range	:	-4°F up to 356°F
Standard Certification	:	Certificate of Conformity Proofload Certificate



Sheaves with roller bearing on request.



Groove size can be modified on request for customized rope sizes.



Available with shackle

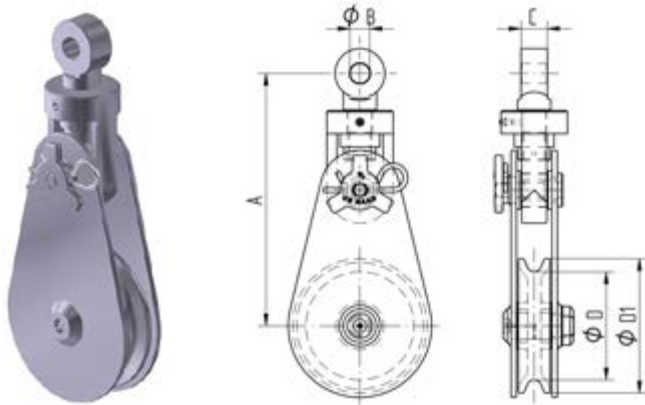

Type	SWL	Rope size	Line pull	Suitable for Shackle	A	ØB	C	ØD	ØD1	Weight
	UST	inch	UST		inch					lbs
H41903	3,6	3/8 - 7/16	1,8	3,6	7 7/16	1 1/16	1	2 7/32	3	8,8
H41905	5,2	7/16 - 9/16	2,6	5,2	9 13/16	2 9/32	1 7/32	3 7/17	4 1/2	19,8
H41906	9,4	2 3/32 - 1 3/16	4,7	9,4	14	1 7/32	1 5/8	4 7/16	6	41,9
H41908	9,4	2 3/32 - 1 3/16	4,7	9,4	15	1 7/32	1 5/8	6 2 7/16	8	52,9
H41910	10,5	2 3/32 - 1 3/16	5,2	10,5	16	1 1/16	1 2 3/32	8 7/16	10	66,1
H41912	10,5	2 3/32 - 1 3/16	5,2	10,5	17 5/8	1 1/16	1 2 3/32	10 7/16	12	86,0
H41914	13,2	2 3/32 - 1 3/16	6,6	13,2	20 5/16	1 1/2	1 2 9/32	12	14	110,2
H41916	14,9	7/8 - 1	7,4	14,9	25 7/16	1 2 3/32	2 1/8	14	16	205,0
H41918	18,7	7/8 - 1	9,4	18,7	27 7/32	1 2 3/32	2 7/32	16 5/8	18	246,9