



# OPEN SPELTER SOCKET WITH SAFETY PIN

Material	:	Cast steel
Working Load Limit	:	20% of the MBL
Finish	:	Painted or galvanised (< Type No. 100 standard galvanised)
Temperature Range	:	-40°F up to 392°F
Standard Certification	:	Certificate of Conformity 3.1 material certificate EN 10204

TYPE APPROVED PRODUCT

DNV•GL

Sockets are Type Approved by DNVGL according DNVGL ST-0378



These sockets include our non-rotating system (NRS-system) which prevents the tump from turning or slipping out of the cone and guarantees a high performance connection.

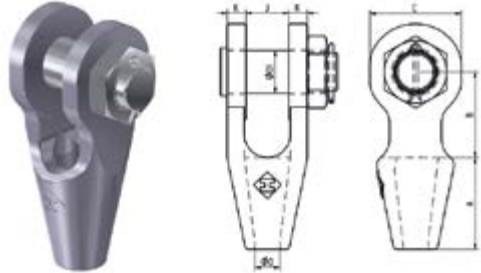

Non-standard sizes or custom products available on request.

NR.	Rope Ø	Article number		MBL	A	B	C	ØD	ØD1	J	K	Weight
	inch	painting RAL 5013 blue	galvanised									
192	¼	-	OSSB192G	8,8	2	1 ¾	1 ¾	¾	2 ¾	2 ¾	¾	0,9
194	⅝ - ¾	-	OSSB194G	13,2	2 ¾	1 ¾	1 ¾	¾	1 ¾	1 ¾	¾	1,8
196	½ - ½	-	OSSB196G	22,0	2 ½	2	1 ¾	¾	1	1	½	2,9
198	⅝ - ¾	-	OSSB198G	33,1	3	2 ½	2 ¾	2 ¾	1 ¾	1 ¾	¾	5,1
100	¾	OSSB100P	OSSB100G	44,1	3 ½	3	3 ¾	1 ¾	1 ¾	1 ½	¾	7,1
104	¾	OSSB104P	OSSB104G	66,1	4	3 ½	3 ¾	2 ¾	1 ¾	1 ¾	2 ¾	11,0
108	1	OSSB108P	OSSB108G	82,7	4 ½	4	4 ½	1 ¾	2	2	2 ¾	19,4
111	1 ¼	OSSB111P	OSSB111G	110,2	5	4 ½	4 ¾	1 ¾	2 ¾	2 ¾	1	25,6
115	1 ¼ - 1 ¾	OSSP115P	OSSB115G	137,8	5 ½	5	5 ¾	1 ½	2 ½	2 ½	1 ¾	35,9
118	1 ½	OSSB118P	OSSB118G	165,3	6	6 ¾	6	1 ¾	2 ¾	3	1 ¾	51,8
120	1 ¾	OSSB120P	OSSB120G	198,4	6 ½	6 ½	6 ¾	1 ¾	3	3	1 ¾	63,9
125	1 ¾ - 1 ¾	OSSB125P	OSSB125G	253,5	7 ½	7	7 ½	2	3 ½	3 ½	1 ½	99,2
128	2 - 2 ¼	OSSB128P	OSSB128G	308,6	8 ½	9	8 ¾	2 ¾	3 ¾	4	1 ¾	142,2
130	2 ¼ - 2 ¾	OSSB130P	OSSB130G	413,4	9	10	8 ¾	2 ½	4 ¾	4 ¾	2 ¾	194,0
132	2 ½ - 2 ¾	OSSB132P	OSSB132G	468,5	9 ¾	10 ¾	9 ¾	2 ¾	4 ¾	5	2 ¾	275,6
135	2 ¾ - 2 ¾	OSSB135P	OSSB135G	551,2	11	11	10 ½	3 ¾	5	5 ¾	2 ¾	357,1
138	3 - 3 ¼	OSSB138P	OSSB138G	661,4	12	11 ¾	10 ¾	3 ¾	5 ¾	5 ¾	3	429,9
140	3 ¼ - 3 ¾	OSSB140P	OSSB140G	771,6	13	11 ¾	11 ¾	3 ¾	5 ½	6 ¾	3 ¾	493,8
142	3 ½ - 3 ¾	OSSB142P	OSSB142G	826,7	14	12 ½	12 ¾	3 ¾	6	6 ¾	3 ¾	617,3
144	3 ¾ - 4	OSSB144P	OSSB144G	1047,2	15	13 ½	13 ¾	4 ¾	7	7 ¾	3 ¾	833,3
146	4 ½	OSSB146P	OSSB146G	1322,8	18 ¾	18 ¾	16 ¾	4 ¾	7 ½	8 ¾	4	1243,4
150	5	OSSB150P	OSSB150G	1543,2	19 ¾	19 ¾	21 ¾	5 ¾	9 ¾	8 ¾	4 ¾	2032,7
160	5 ½ - 6	OSSB160P	OSSB160G	2204,6	22 ¾	19 ¾	23 ¾	6 ¾	10 ¾	9 ¾	5 ½	2855,0
170	6 ½	OSSB170P	OSSB170G	2755,8	26 ¾	23 ¾	25 ¾	6 ¾	11 ¾	12 ¾	6 ¾	4299,0