

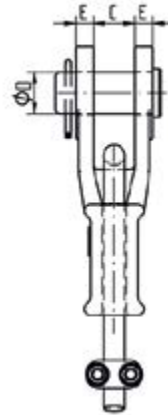

# OPEN WEDGE SOCKET WITH PIN

Material	:	Cast steel
Working Load Limit	:	20% of the MBL
Finish	:	Painted or Galvanised (< Type No. 6 standard galvanised)
Temperature Range	:	-40°F up to 392°F
Standard Certification	:	Certificate of Conformity 3.1 material certificate EN 10204

**Non-standard sizes or custom products available on request.**

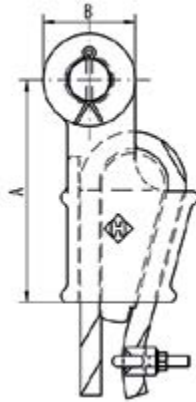

NR.	Rope Ø inch	Article number		MBL USt	A	B	C	ØD	E	Weight lbs
		painting RAL 5013 blue	galvanised							
0.5	3/8	-	OWSP0,5G	11,0	5 3/4	1 29/32	1 1/16	1 1/16	7/16	3,7
1	1/2	-	OWSP1G	17,6	5 3/4	2 7/32	1	1	1/2	5,1
2	5/8	-	OWSP2G	27,6	6 29/32	2 19/16	1 1/4	1 7/32	5/8	8,6
3	3/4	-	OWSP3G	35,3	8 5/16	3 1/8	1 1/2	1 7/16	5/8	13,4
4	7/8	-	OWSP4G	49,6	9 7/16	3 19/16	1 29/32	1 3/8	29/32	20,5
5	1	-	OWSP5G	77,2	10 13/16	4 1/2	2	2	29/32	32,6
6	1 1/8	OWSP6P	OWSP6G	110,2	12 7/32	5 1/8	2 7/32	2 7/32	1	46,5
7	1 1/4	OWSP7P	OWSP7G	121,3	13 13/16	5 29/32	2 1/2	2 1/2	1 1/8	72,3
8	1 3/8	OWSP8P	OWSP8G	137,8	15 13/16	5 19/16	2 29/32	2 1/2	1 1/8	86,6
9	1 1/2	OWSP9P	OWSP9G	165,3	17 29/32	6 3/16	2 29/32	2 13/16	1 7/32	115,7
10	1 5/8	OWSP10P	OWSP10G	220,5	19 29/32	6 29/32	2 29/32	2 29/32	1 3/8	148,8
11	1 3/4 - 1 7/8	OWSP11P	OWSP11G	286,6	21 29/32	7 29/32	3 1/2	3 1/2	1 1/2	216,5
12	2	OWSP12P	OWSP12G	308,6	25 %	7 29/32	3 29/32	3 29/32	1 13/16	270,1
13	2 1/4	OWSP13P	OWSP13G	396,8	25 29/32	9 19/16	4 1/2	4 1/16	2 1/8	393,3
14	2 1/2	OWSP14P	OWSP14G	496,0	33 1/8	10 3/8	5	4 13/16	2 7/16	619,5
15	3	OWSP15P	OWSP15G	573,2	39 7/16	11 19/16	5 29/32	5 7/32	3	1034,0
16	3 1/4 - 3 3/8	OWSP16P	OWSP16G	688,9	43 3/16	11 13/16	6 3/16	5 1/2	3 3/8	1344,8